

# Initial C™: Single use clavicle sterile kits

## Initial C™ - Clavicle kits contents



### Indications:

The implants of the Initial C™ are dedicated to the fixation of fractures, mal-union, non-unions, and osteotomies of the clavicle in adults.

### Contraindications:

- Serious vascular deterioration, bone devitalization,
- Pregnancy.
- Acute or chronic local or systemic infections.
- Lack of musculo-cutaneous cover, severe vascular deficiency affecting the concerned area.
- Insufficient bone quality preventing a good fixation of the implants into the bone,
- Muscular deficit, neurological deficiency or behavioral disorders, which could submit the implant to abnormal mechanical strains.
- Allergy to one of the materials used or sensitivity to foreign bodies.
- Serious problems of non-compliance, mental or neurological disorders, failure to follow post-operative care recommendations.
- Unstable physical and/or mental condition.

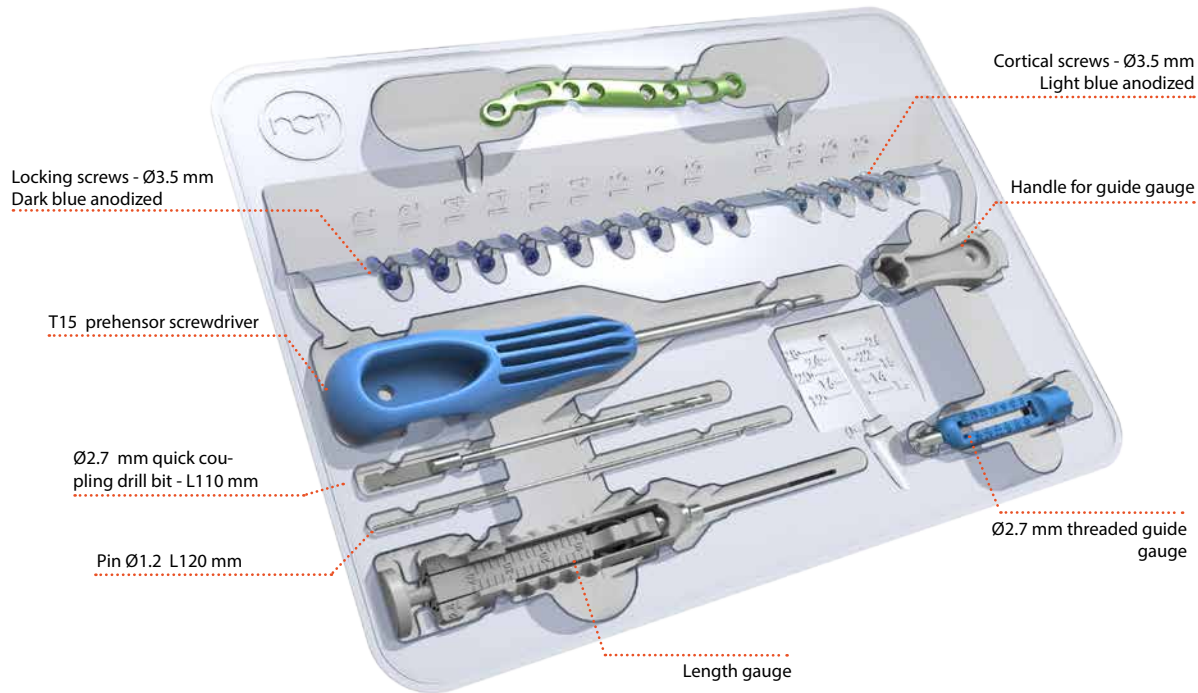

## > Initial C™ kits references

### INITIAL C™ KITS - MEDIAL PLATES AND MEDIAL LATERAL PLATES

Ref.	Description
KIT-CM2D	Clavicle kit - Medial - Right - Size 2
KIT-CM2G	Clavicle kit - Medial - Left - Size 2
KIT-CML2D	Clavicle kit - Medial Lateral - Right - Size 2
KIT-CML2G	Clavicle kit - Medial Lateral - Left - Size 2

### INITIAL C™ KITS CONTENT - IMPLANTS

	Ref.	Description	QUANTITY	
			KIT-CM2D/G	KIT-CML2D/G
PLATES	CTDM2D or CTGM2D	Clavicle plate - Medial part - Size 2 - Right or Left	1	-
	CTDML2D or CTGML2D	Clavicle plate - Medial lateral part - Size 2 - Right or Left	-	1
STANDARD CORTICAL SCREWS Ø3.5 MM	CT3.5L14D	Standard cortical screw - Ø3.5 mm - L 14 mm	2	2
	CT3.5L16D	Standard cortical screw - Ø3.5 mm - L 16 mm	2	2
LOCKING SCREWS Ø3.5 MM	SOT3.5L12D	Locking screw - Ø3.5 mm - L 12 mm	1	2
	SOT3.5L14D	Locking screw - Ø3.5 mm - L 14 mm	3	4
	SOT3.5L16D	Locking screw - Ø3.5 mm - L 16 mm	3	3
	SOT3.5L18D	Locking screw - Ø3.5 mm - L 18 mm	1	-



NEWCLIP-TECHNICS



# Initial C™ kits

## Surgical technique

Example: surgical technique with a medial lateral plate, size 2 (KIT-CML2D)



1. Using the medial and medial lateral templates (ANC838), define the suitable plate, then determine the appropriate kit.

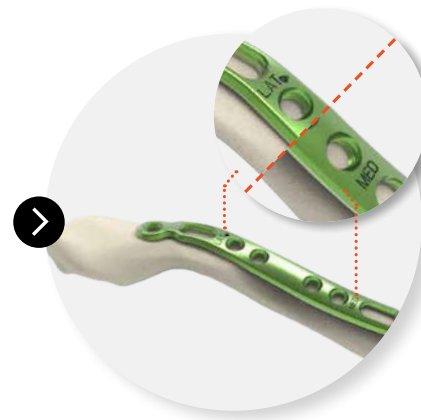

2. Position the plate making sure the 'LAT' and 'MED' marks correctly matched.

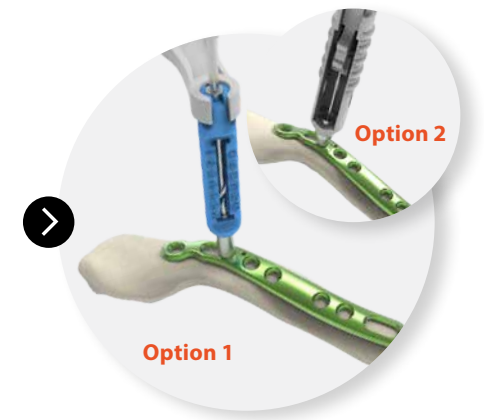

**Option 1**

3. Snap the handle for guide gauge and perform the drilling using  $\varnothing 2.7$  mm threaded guide gauge into the lateral oblong hole.

**Option 1:** Measure the screw length directly on the gauge.  
**Option 2:** The drilling depth can be measured by inserting the length gauge.

### Handle for guide gauge



Before performing the drilling into the oblong hole, snap the handle for guide gauge on the  $\varnothing 2.7$  mm threaded guide gauge (blue).

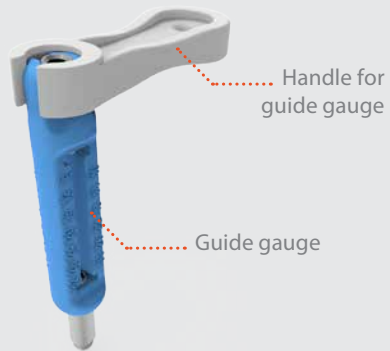

Handle for guide gauge

Guide gauge

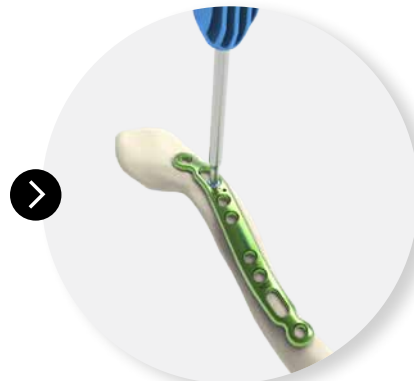

4. Then insert the  $\varnothing 3.5$  mm cortical screw using the T15 screwdriver. Repeat the same procedure for the medial oblong hole.

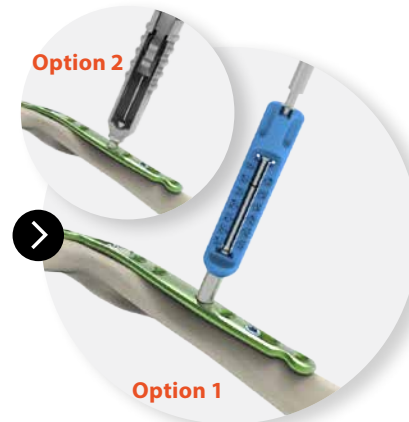

**Option 1**

5. Using the  $\varnothing 2.7$  mm threaded guide gauge, drill ( $\varnothing 2.7$  mm).  
**Option 1:** Measure the screw length directly on the gauge.  
**Option 2:** The drilling depth can be measured by inserting the length gauge.

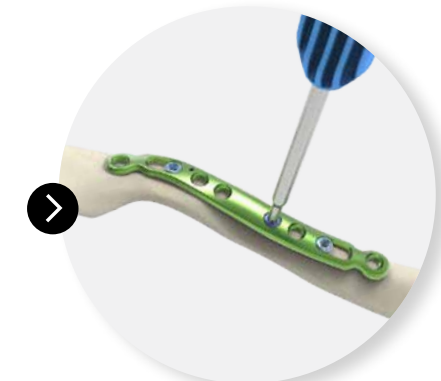

6. Insert the  $\varnothing 3.5$  mm locking screw using the T15 screwdriver.

### Final result



**Repeat previous steps to insert the remaining  $\varnothing 3.5$  mm locking screws in the plate.**



NEWCLIP TECHNICS  
PA de la Lande Saint Martin - 45 rue des Garottières  
44115 Haute Goulaine (France)  
Tél. : +33 (0)2 28 21 37 12 - Fax : +33 (0)2 40 63 68 37  
Mail : [orders@newcliptechnics.com](mailto:orders@newcliptechnics.com)  
[www.newcliptechnics.com](http://www.newcliptechnics.com)

NEWCLIP USA  
642 Larkfield Center  
Santa Rosa CA 95403, USA  
Phone : + 1 707 230 5078  
Mail : [customerservice@newclipusa.com](mailto:customerservice@newclipusa.com)  
[www.newclipusa.com](http://www.newclipusa.com)

The information presented in this brochure is intended to demonstrate a Newclip Technics product. Always refer to the package insert, product label and/or user instructions before using any Newclip Technics product. Surgeons must always rely on their own clinical judgment when deciding which products and techniques to use with their patients. Products may not be available in all markets. Product availability is subject to the regulatory or medical practices that govern individual markets. Please contact your Newclip Technics representative if you have questions about the availability of Newclip Technics products in your area.

